

PRODUCT MODELS (North America & Europe)

- Oasis cover

PURPOSE OF THE PROCEDURE

This procedure indicates how to unpack an Oasis replacement inner shell, outer shell, or cover.

PREPARATION

Gather the required tools, as seen in the table below.

TOOLS REQUIRED	
Phillips screwdriver	Robertson screwdriver
Hammer	3/8" Socket wrench and spanner

Version française à la page 3.

NOTE

If you find any damage, refer to the Covana damaged claim form attached to the crate, take pictures and simply refuse the delivery from the carrier.

UNPACKING PROCEDURE

- 1) Before unpacking the unit, make sure there is no visible damage to the crate. In case of any suspicious damage, take pictures first and please call Covana customer service immediately. Always stand the crate in the vertical position. Make sure the wind conditions are safe enough when unpacking the components.

- 2) Remove both cardboards.

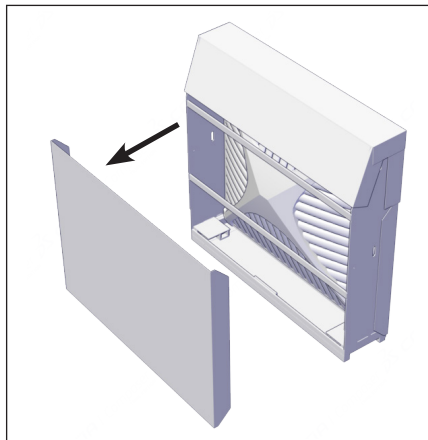

IMAGE 1

- 3) Hammer off the wood furring strips by hitting on the inside of the side panels.

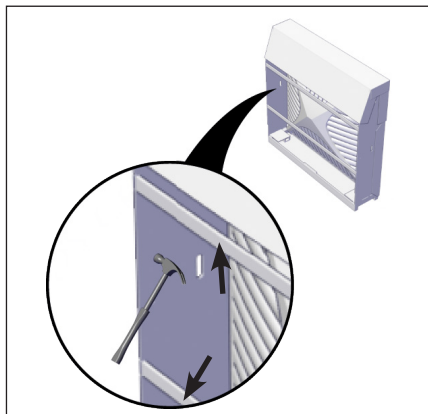

IMAGE 2

⚠ CAUTION

Be careful not to damage the cover components and other parts in the crate.

Flatten all protruding nails.

- 4) With the help of another person, gently lay the crate horizontally on its back by using the pivot point (see image 3).

⚠ CAUTION

Dropping the crate could damage the cover.

- 5) Remove the cardboard top and sides by simply unfolding them on the ground.

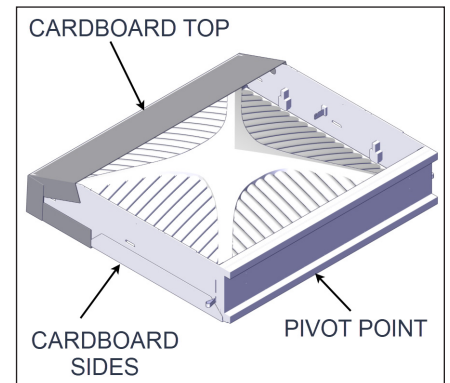

IMAGE 3

- 6) Gently hammer off the last wood furring strips on the front of the crate. Consider hammering the side panel in an outward direction to prevent damaging the cover.

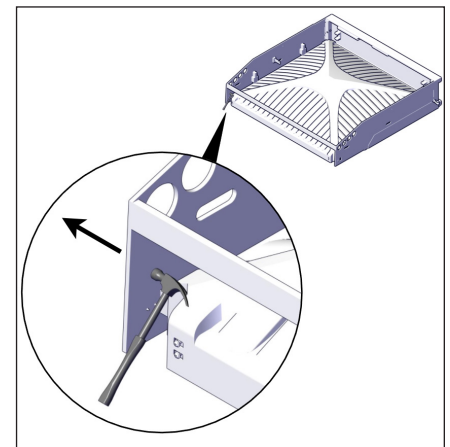

IMAGE 4

⚠ CAUTION

Be careful not to damage the cover during this process (see image 4).

- 7) This step is divided in 3 substeps:
- Substep 1: Use a Phillips screwdriver to remove the two M6 x 20 mm screws.
 - Substep 2: Use a 3/8" socket wrench to remove the two other lag bolts.
 - Substep 3: Repeat steps 1 and 2 for all four corners (see image 5).

⚠ CAUTION

Carefully remove all four brackets. Failure to do so might damage the cover when removing the crate sides. Flatten any protruding nails.

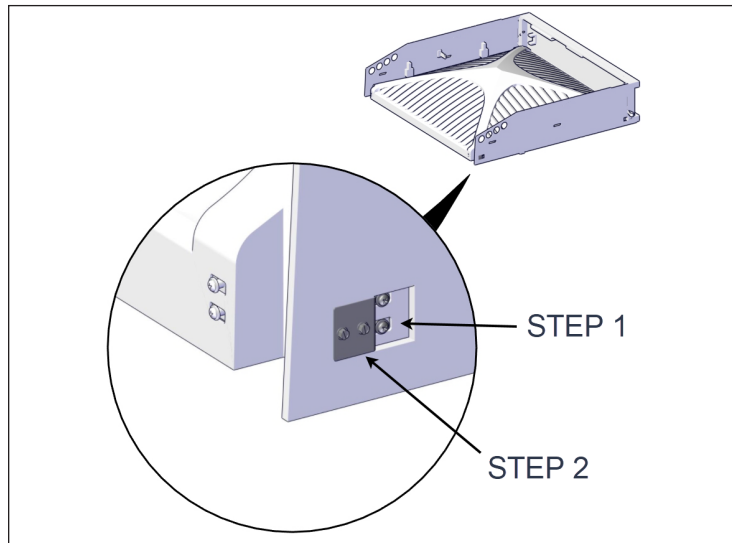

IMAGE 5

- 8) Use the Robertson screwdriver to remove the three no. 8 x 1½" screws holding both side panels to the bottom of the crate (see image 6).

⚠ CAUTION

Remove side panels with care. The side panels could fall on the cover.

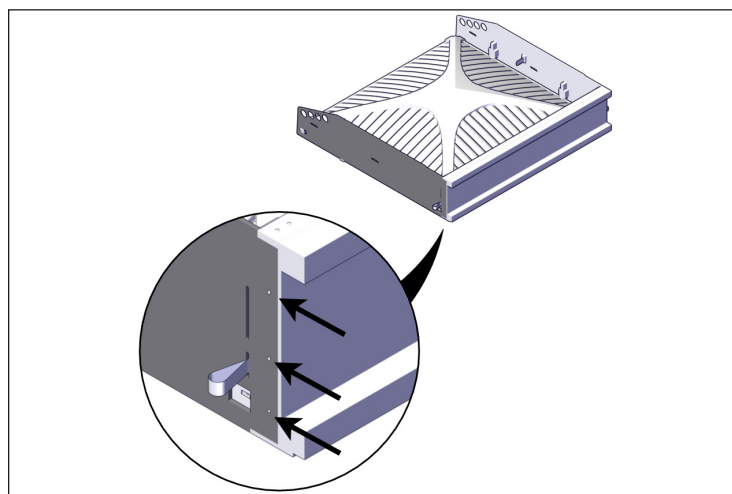

IMAGE 6

- 9) Pivot the side panels by gently prying them outward; lay the panels down on the ground (see image 7).

⚠ CAUTION

Do not remove the side panels completely, doing so might damage the cover.

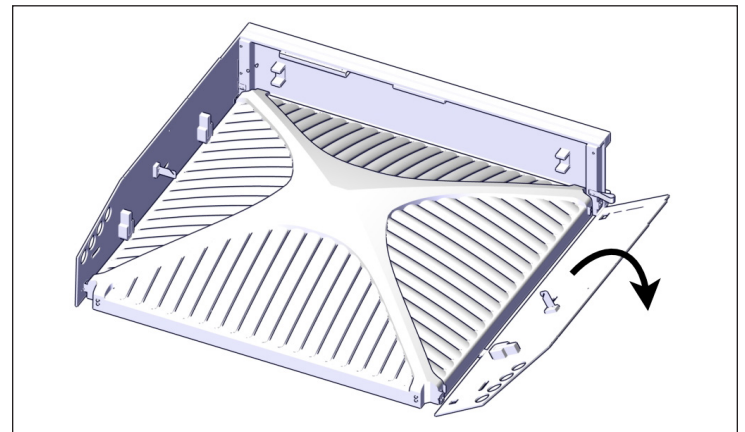

IMAGE 7

- 10) Pull the bottom section out, making sure that it does not interfere with the cover. If it does, gently lift the cover near the bottom section and continue pulling it out (see image 8).

⚠ CAUTION

Do not flip the bottom section, this might scratch the cover if the nails are protruding from the wood. Pulling the bottom section is the best method to ensure no aesthetic damage. Flatten any protruding nails.

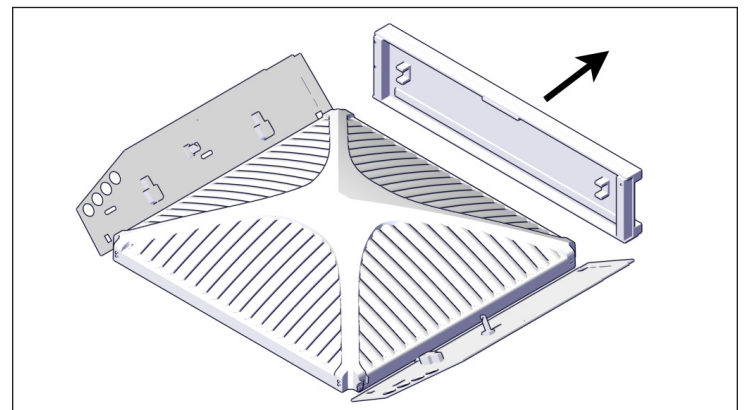

IMAGE 8

⚠ CAUTION

When handling the cover, two people must support it with both hands. A wide grip is recommended when handling the cover, as all four sides must be lifted equally. Failure to follow these instructions will cause permanent damage to the cover.